

NOTES:

1. REMOVE ALL BURRS AND SHARP EDGES.
2. MATERIAL: 6061-T6 ALUMINUM
3. FINISH: ELECTROLESS NICKEL PLATED MIL-C-26074C, CLASS 1, .00028-.00032 MAX. THICKNESS.

REVISIONS		ECO	BY	DATE
DESCRIPTION	REV			
PRELIMINARY RELEASED	001	-		
	002	-		

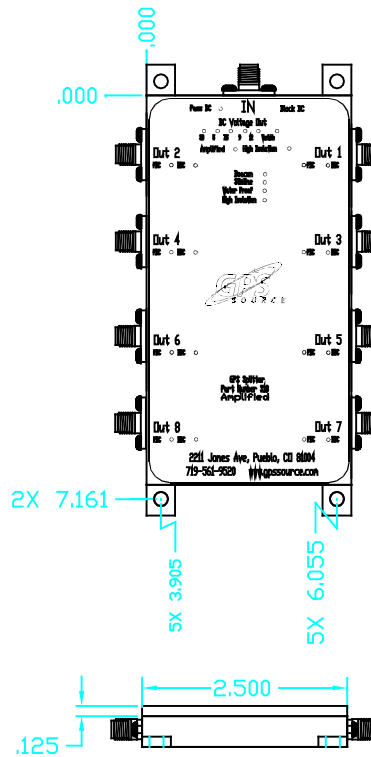
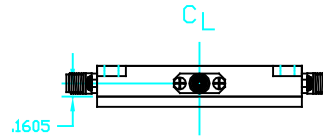
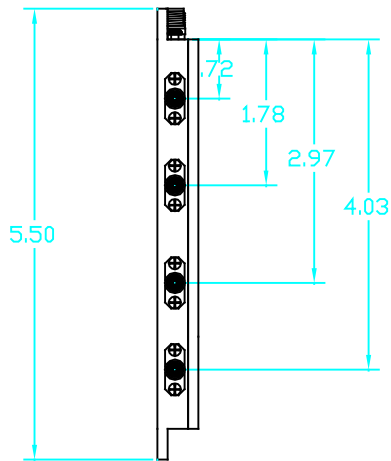

CUTAWAY AT C_L

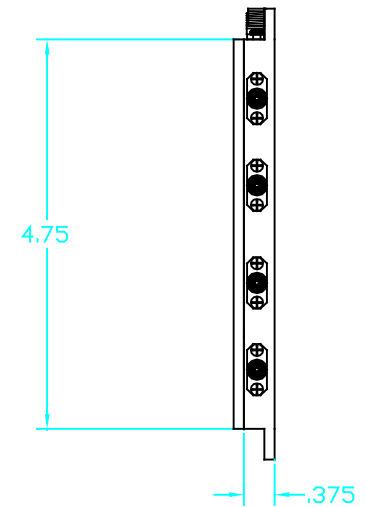

NEXT ASSEMBLY USED ON MATERIAL:		THIRD ANGLE PROJECTION		DIMENSIONS ARE IN INCHES. TOLERANCES: XX = ± .01 XXX = ± .005 XXXX = ± .0005 ANGULAR = ± 1°		DRAWN: A.SOTO		25 FEB 2006		TITLE: HOUSING, 1X8 LP	
FINISH:		DIA CONCENTRIC WITHIN .005 TOTAL INDICATOR RUNOUT: SURFACE 32/ OR BETTER. DIMENSIONAL LIMITS APPLY TO FINISHED PART.		CHECKED:		PROJ ENG:		APPD:		SIZE: C DWG NO: Housing_CON_1X8S_LP_001.dwg REV: 001	
						SCALE: 1/1		SHEET 1 OF 1			